

QUANTITY	PART NUMBER	ITEM NO.	PART NAME	VENDOR	MOLD NO.	MATERIAL	MAT. MFR	COLOR	REV.	REVISION DATE
XXX	km180909120801A1		AGORA		NA				A	2019-07-02
1		1	BATTERY PACK, 2x18650							
3	WN 5411 C 18x5	2	SCREW, DELTA PT, M1.8 x 5mm	EJOT						
8	WN 5412 H 20x7	3	SCREW, DELTA PT, M2.0 x 7mm	EJOT						
2	96817A890	4	SCREW, M2.5 by 5mm	McMaster Carr		ANSI 316, Stainless Steel	CAD, Generic			
2	90945A707	5	WASHER	McMaster Carr		ANSI 316, Stainless Steel	CAD, Generic			
1	MF3	6	ANTENNA, MF3	TAOGLAS						
1	KM180909125501A1	7	TOP HOUSING	ACORE	TBD			PANTONE 7698C	A	2018-10-10
1	km190618085201A1	8	BASE, 18650 x2	ACORE	EPI-1906271	PC-110U	CHIMEI	PANTONE 7698C	A	2019-06-28
1	km190618101301A1	9	COVER 18650	ACORE	EPI-1906271	PC-110U	CHIMEI	PANTONE 7698C	A	2019-06-28

CREO 5.0 DWG Format

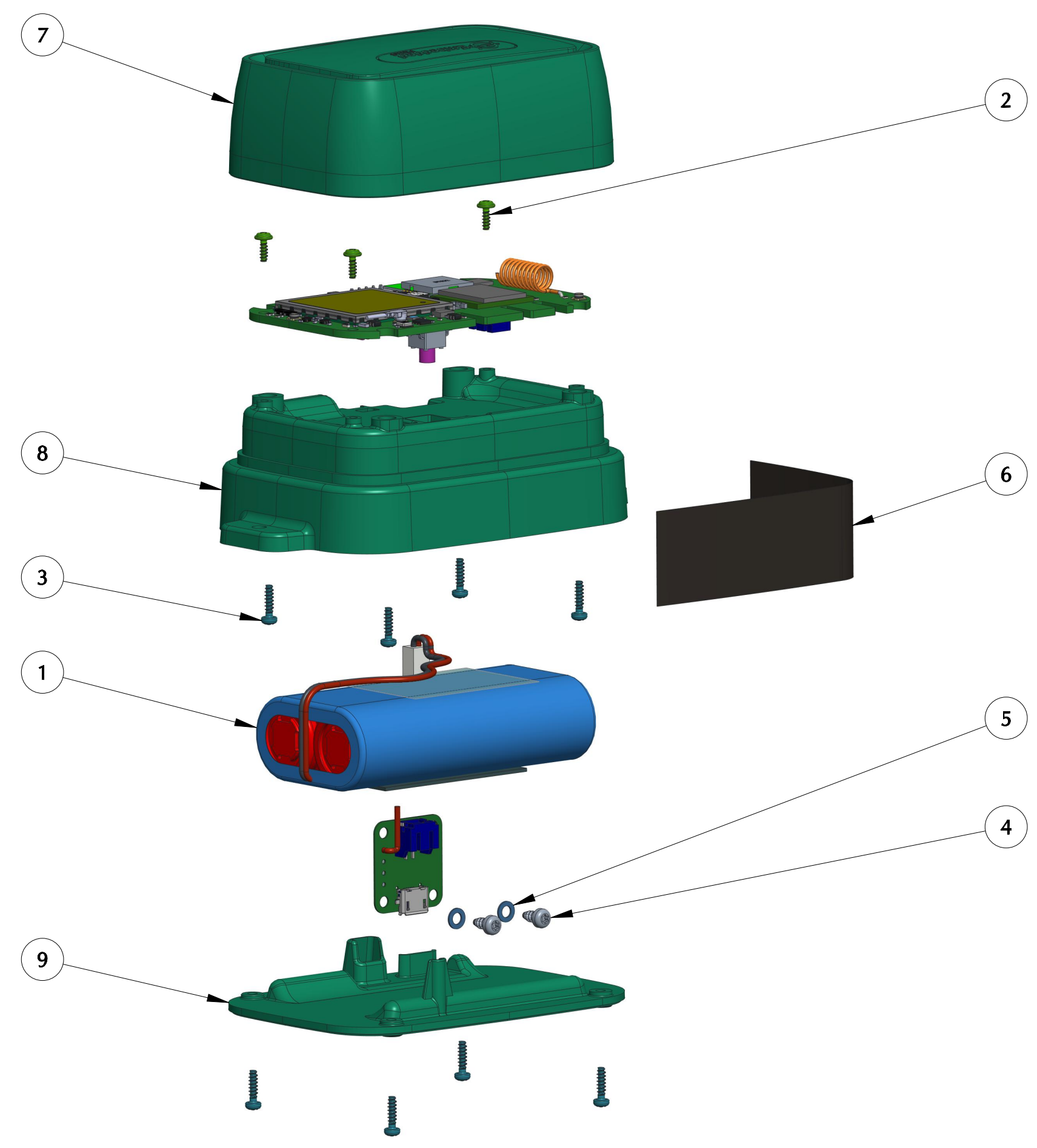

<b>SHI</b>	STUDIO H, Inc CLEVELAND, OHIO +1-216-650-1724			CAD FILE: KM190623080901_AGORA	
	This document contains confidential and proprietary information of Studio H, Inc. Neither this document nor the information herein are to be reproduced, distributed, used or disclosed, either in part or in whole, except as specifically authorized by Studio H, Inc.				
DWN C.Miedza CKD		ENG C.Miedza MFG.	C.D.	FIRST MADE FOR:	
DATE 2018-09-26 DATE		DATE 2019-07-02 DATE	DATE	PART NO. <b>km180909120801A1</b>	1 SHEET OF 1