

4

3

2

1

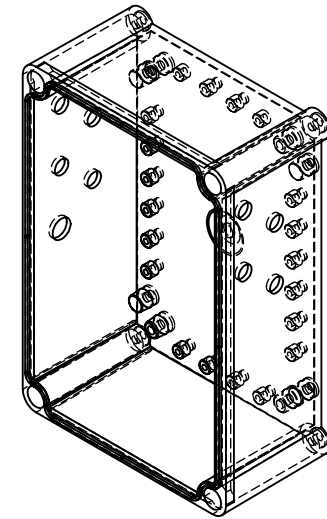
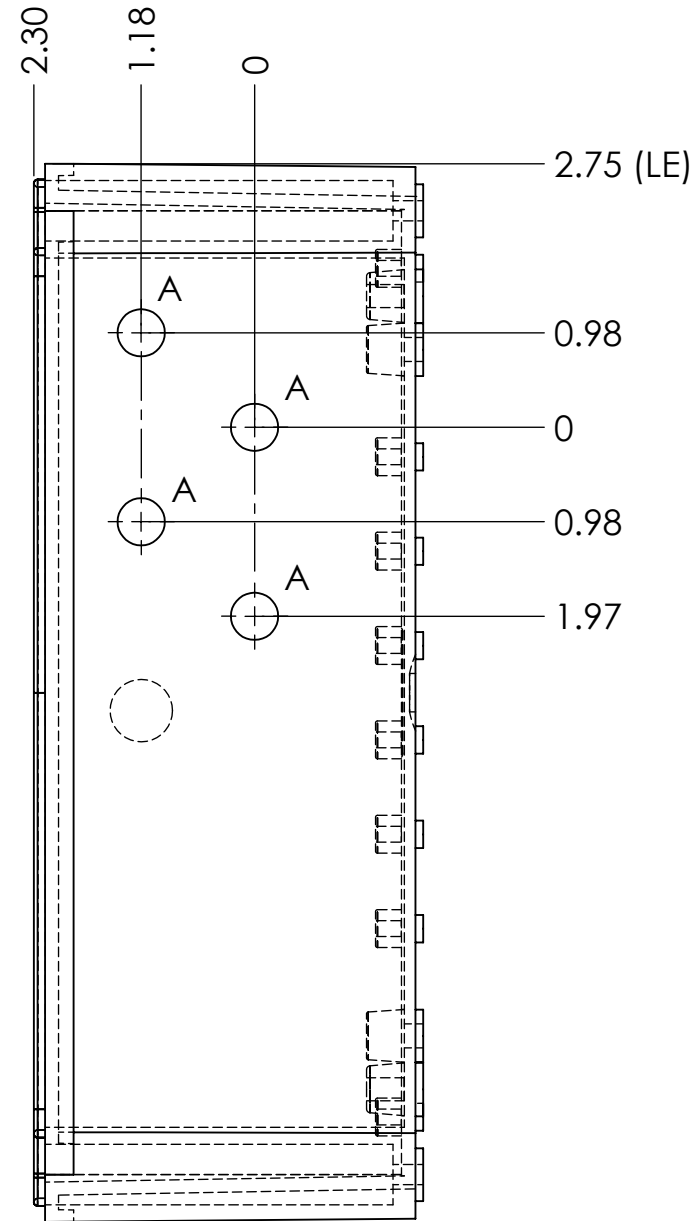
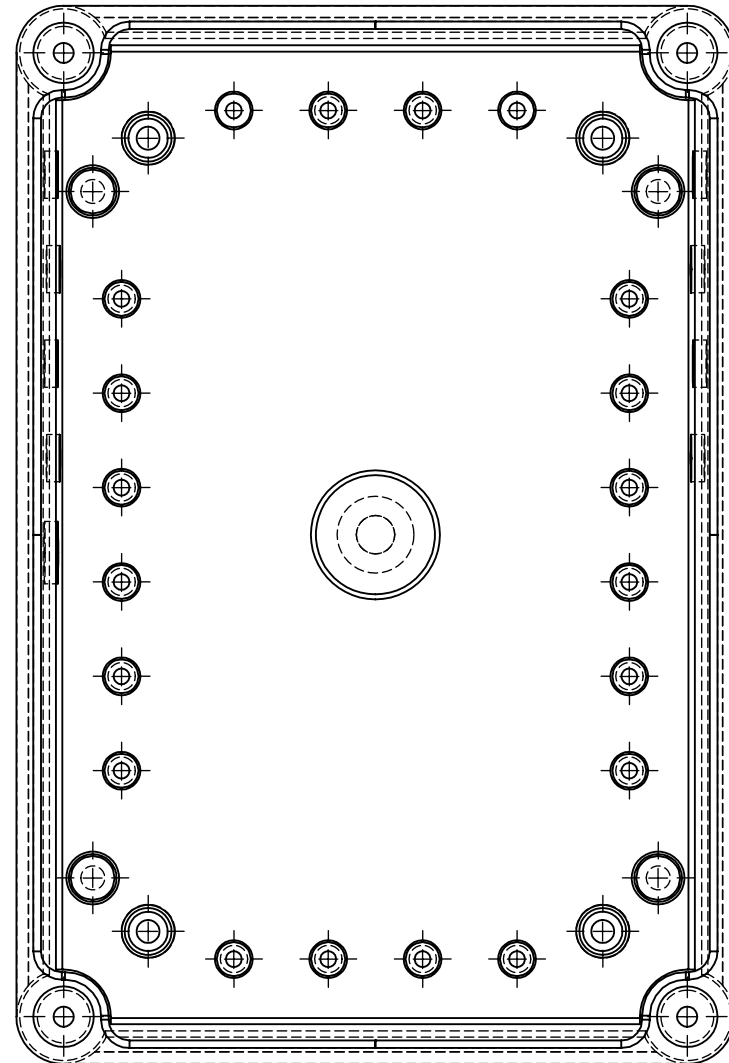
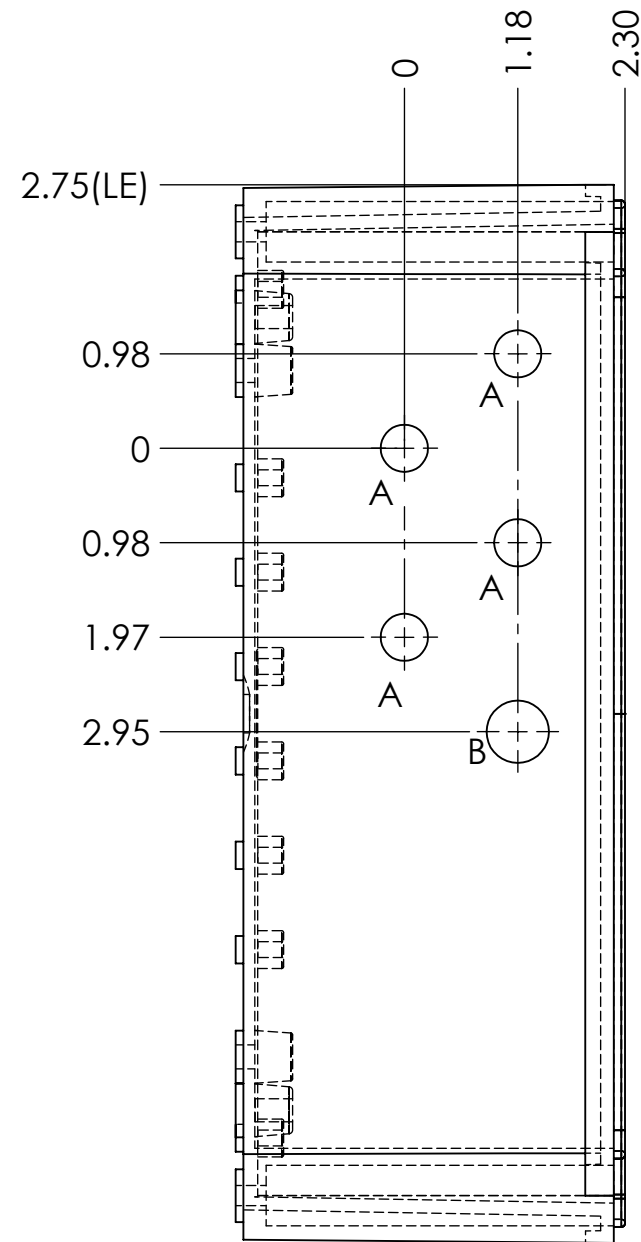

NOTES:

- 1.) MATERIAL: BUD INDUSTRIES PTS-25340. MODIFIED AS DESCRIBED ON THIS DRAWING.
- 2.) TOP OF BOX AND BAG OF HARDWARE NOT SHOWN.

HOLES:

- A - 8 X  $\phi 15/32 \pm 0.005$  THRU
- B - 1 X  $\phi 5/8 \pm 0.005$  THRU

UNLESS OTHERWISE SPECIFIED  
DIMENSIONS IN INCHES  
TOLERANCES:  
TWO PLACE DECIMAL:  $\pm 0.015$   
THREE PLACE DECIMAL:  $\pm 0.005$   
ANGLE:  $\pm 0.5^\circ$

PROPRIETARY AND CONFIDENTIAL  
THIS DOCUMENT CONTAINS CONFIDENTIAL  
AND PROPRIETARY INFORMATION.  
NEITHER THE DOCUMENT, NOR  
REPRODUCTIONS OF IT, NOR  
INFORMATION DERIVED FROM IT, IS  
TO BE GIVEN TO OTHERS.  
COPYRIGHT © 2020  
EMBEDDED PLANET, INC.  
ALL RIGHTS RESERVED.



GEOMETRIC  
TOLERANCING PER: ASME Y 14.5

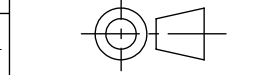

THIRD ANGLE PROJECTION  
DRAWN BY (NAME & DATE)  
TIMESKI 4MAR20

SolidWorks 2016  
DO NOT SCALE DRAWING

TITLE  
**MODIFIED  
POLYCARBONATE BOX**

DWG. NO.  
**P12100000000377**

REV  
**A**

B SIZE    SCALE 1:2    SHEET 1 OF 1

4

3

2

1

B

B

A

A